



Supply Air Unit
SAU

web-version

SAU Supply air unit

SAU is designed to give a pleasant indoor climate, controlling the heat and providing clean air.

SAU is delivered complete with filter, fan and heater. SAU 125 and 200 can be controlled with a control-unit with two switches; heater on/off and fanspeed 0/1/2.

The electrical elements are also possible to regulate externally together with a pulser.

To regulate SAU 250 E with water battery, use 3-way valve and control equipment. SAU can be mounted in a warm or cold area, as it is insulated with 50 mm mineral wool covered with pre-galvanized sheet metal.

Alternative filters for the unit are: G4, F5 and F7 (see diagram).

SAU 125

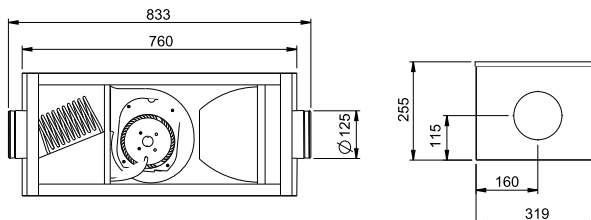

SAU 200

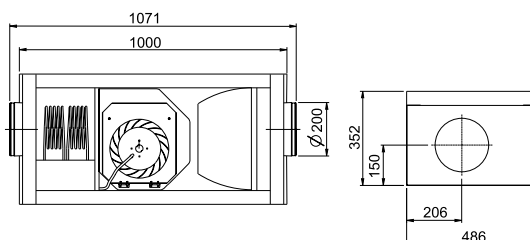

SAU 250 E

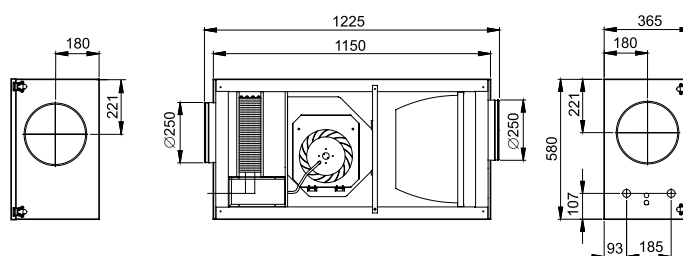

Technical data

N. B. WATER BATTERY

SAU	SAU 125 A	SAU 125 C	SAU 200 B1	SAU 200 B3	SAU 200 C3	SAU 250 E
Voltage	230V 50Hz	230V 50Hz	230V 50Hz	3x400V 50Hz	3x400V 50Hz	230V 50Hz
Voltage with pulser	230V 50Hz	230V 50Hz	230V 50Hz	2x400V 50Hz	2x400V 50Hz	-
Fan power	41W	110W	105W	105W	160W	192W
Heater power	1000W	2000W	2000W	4400W	4400W	see techn data
Total power	1041W	2110W	2105W	4505W	4560W	192W
Current	4,5A	9,2A	9,2A	11A	11A	0,84A
Weight	20 kg	20 kg	31 kg	33 kg	35 kg	45 kg
Duct connection Ø	Ø125	Ø125	Ø200	Ø200	Ø200	Ø250

Terminal block for connection of external control unit is placed inside the unit. Wiring diagram is enclosed with the unit. Connections must be made by authorised electrician.

We preserve the rights to changes without further notice.

Sound data SAU 125

To environment

SAU 125 A	LpA	LWA tot dB	63	125	250	500	1K	2K	4K	8K
Flow 30 l/s	38	45	29	33	38	41	36	33	30	32
SAU 125 C	LpA	LWA tot dB	63	125	250	500	1K	2K	4K	8K
Flow 70 l/s	41	48	29	38	44	45	39	36	32	32

Outlet

SAU 125 A	LpA	LWA tot dB	63	125	250	500	1K	2K	4K	8K
Flow 30 l/s	52	59	50	54	50	51	54	48	42	36
SAU 125 C	LpA	LWA tot dB	63	125	250	500	1K	2K	4K	8K
Flow 70 l/s	58	65	54	60	56	56	58	57	49	45

Sound data SAU 200

To environment

200 B1/B3	LpA	LWA tot dB	63	125	250	500	1K	2K	4K	8K
Flow 120 l/s	44	51	42	38	43	49	42	39	34	31
200 C3	LpA	LWA tot dB	63	125	250	500	1K	2K	4K	8K
Flow 100 l/s	46	53	42	41	47	49	44	41	37	33

Outlet

200 B1/B3	LpA	LWA tot dB	63	125	250	500	1K	2K	4K	8K
Flow 120 l/s	63	70	53	56	62	67	64	59	52	40
200 C3	LpA	LWA tot dB	63	125	250	500	1K	2K	4K	8K
Flow 100 l/s	65	72	55	60	64	68	66	61	54	46

Sound data SAU 250 E*

250 E	LpA	LWA tot	63	125	250	500	1K	2K	4K	8K
To environment	50	57	42	50	53	52	42	39	37	37
Outlet		77	56	70	74	71	64	64	62	53

*Measured at 160 l/s, 300 Pa with G4-filter.

Explanations to sound data

The sound data have been compiled by means of sound measurement methods as follows:

Pressure and flow: ISO 5801

Determination of acoustic sound level in duct: ISO 5136

Determination of acoustic sound level in reverberation room: ISO 3741

Designations

L_{WA} tot: Total A-weighted sound power level dB(A) (ref 10^{-12} W) = the sum of the sound power level in the octave ranges.

L_{WA} : A-weighted sound power level in octave range dB(A) (ref 10^{-12} W).

L_{pA} : A-weighted sound pressure level in dB(A) according to normed A-weighting correction and relating to an effective absorption area of 20 m² with half spherical translation at a distance of 3 meters.

Technical data

Water battery at airflow :

250l/s och 45°C DT

Power	Water temp	Pressure drop	Flow	Connection
14,7kW	60/40	11,2kPa	0,18l/s	18mm

200l/s och 50°C DT

Power	Water temp	Pressure drop	Flow	Connection
12,7kW	60/40	8,5kPa	0,15l/s	18mm

150l/s och 55°C DT

Power	Water temp	Pressure drop	Flow	Connection
10,3kW	60/40	5,9kPa	0,12l/s	18mm

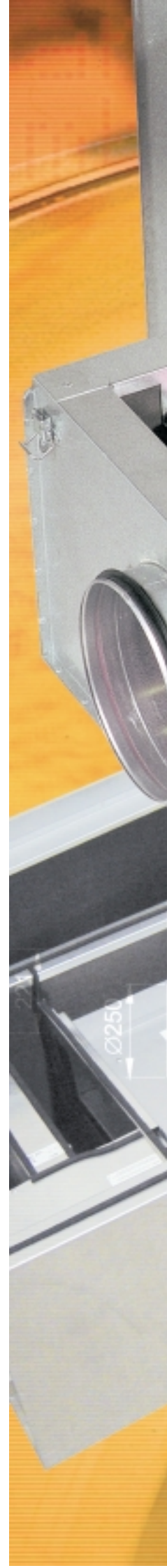

Pressure and flow

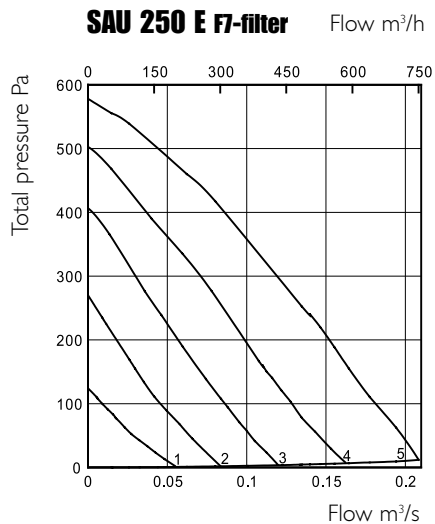
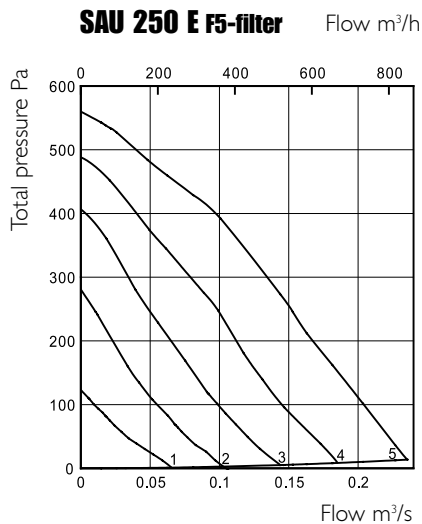
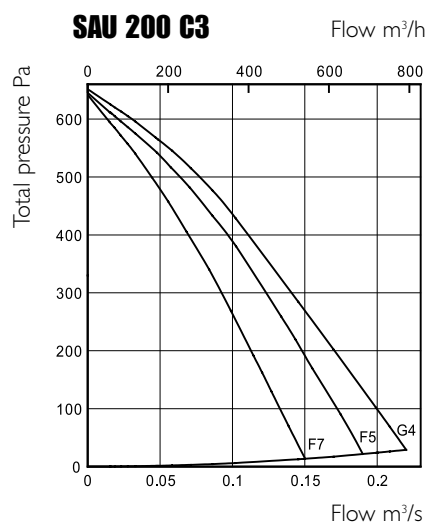
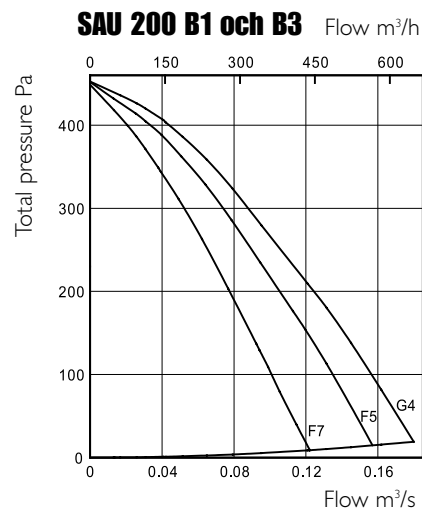
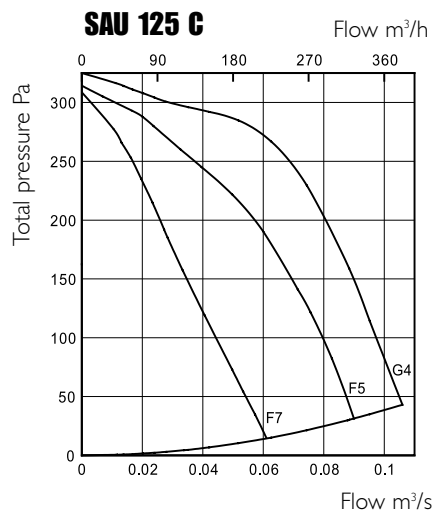
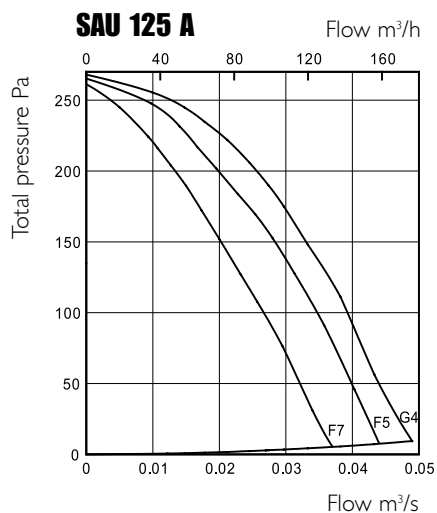

Transformer curves SAU 250 E

Curve no	1	2	3	4	5
	80V	110V	135V	165V	230V

ÖSTBERG
THE FAN COMPANY

AB C.A. ÖSTBERG
INDUSTRIGATAN 2
SE-774 35 AVESTA
SWEDEN

TEL +46 226-86 000
FAX +46 226-86 005

e-mail: info@ca-ostberg.se
www.ostberg.com